

Features

- Carbon element
- Knurled / flatted / plain shaft styles
- Reverse log / linear / log taper option
- Rotary switch
- RoHS compliant*

RK09H Series - 9 mm Multi-Ganged Potentiometer /Rotary Switch

Electrical Characteristics

Standard Resistance Range 1 K ohms to 1 M ohms
 Total Resistance Tolerance ±20 %
 Standard Tapers Linear & Reverse log & Log
 Maximum Operating Voltage 50 VAC, 10 VDC
 Rated Power..... 0.05 watts
 Noise68 mV max.
 Insulation Resistance @ 250 VDC 100 M ohms min
 Dielectric Withstanding Voltage ..300 VAC
 Total Resistance error 20%R

Environmental Characteristics

Operating Temperature -10 °C to +75 °C
 Rotational Life.....10,000 cycles

Switch Characteristics

Contact Resistance 50 milliohms max.
 Rated Power..... 3 A @ 16 VDC
 Switch Torque 100 - 500gf-cm
 Switch Angle.....50 ° max.

Mechanical Characteristics

Mechanical Angle 300 ° ±10 °
 Rotational Torque20 to 150 gf-cm
 Stop Strength.....4.0 kgf-cm min
 Shaft Wobble..... 0.5 x L/30 mm p-p max.
 L=Shaft length

Soldering Condition

Manual Soldering

..... 350 °C max. for 3 seconds

Dip Soldering

..... 260 °C max. for 5 seconds

Mounting Hardware

.....One flat washer and one hex nut supplied per potentiometer

Materials

Shaft.....Aluminum
 Bushing.....Zinc alloy
 Driving plate&Driving head.....POM
 Rivet.....Aluminum
 Reed.....Phosphor copper
 Base.....PBT
 Carbon plate.....FR4 substrate
 Terminal.....Cold rolled strip
 Cover plate.....PBT
 Bracket.....Cold rolled strip
 Switch strut.....Brass
 Blade of knife switch.....Brass
 Switch terminal.....Brass
 Spring.....Spring wire

Derating Curve

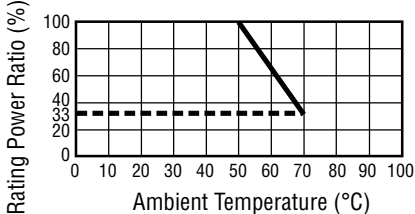

How To Order

RK09 H - 1 - A - 15 K - B 103 - 0

Model _____

- RK09 = With Rotary Switch

Structure _____

- H = Horizontal

No. of Sections _____

- 1 = 1 Section
- 2 = 2 Sections

Bushing length _____

- A = 5 mm
- B = 7 mm

Shaft Length _____

- 15 = 15 mm
- 20 = 20 mm
- 25 = 25 mm

Shaft Styles _____

- K = Knurled Type Shaft (Metal)
- F = Flatted Metal Shaft
- P = Plain Metal Shaft

Resistance Taper _____

- A = Reverse log
- B = Linear
- C = Log

Resistance Code _____
(See Table)

Detent options _____

- 0 = No detent
- 1 = 41 detents

Standard Resistance Table

Resistance (Ohms)	Resistance Code
1,000	102
2,000	202
5,000	502
10,000	103
20,000	203
50,000	503
100,000	104
200,000	204
500,000	504
1,000,000	105

Typical weight

1 pc of RK09H weight.....5.5g±2g

Hardware

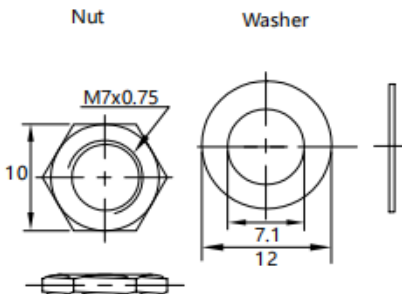

Tapers

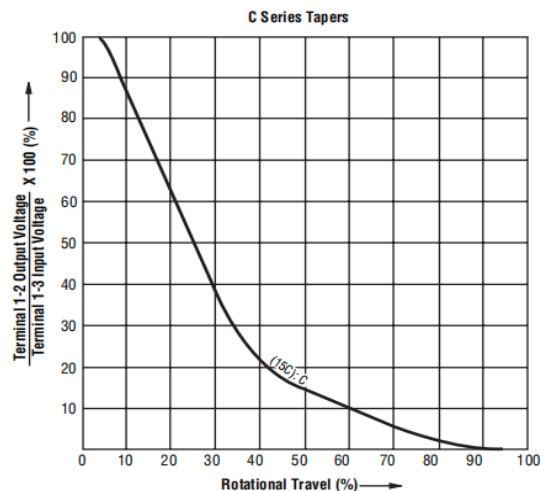
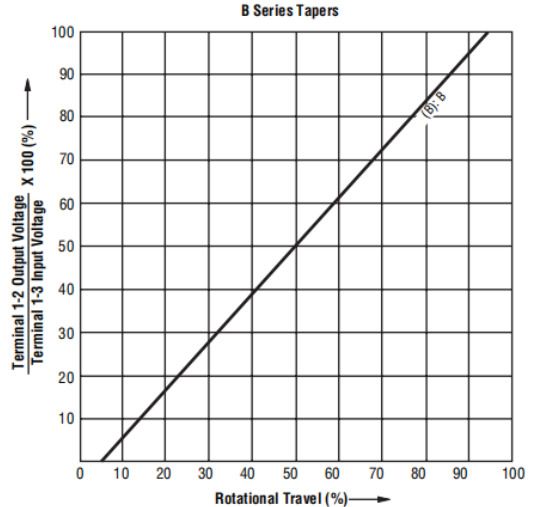
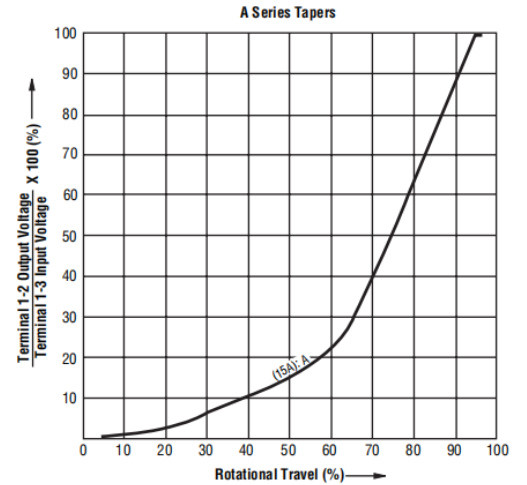

Applications

- Audio/TV sets
- Automotive sound systems
- Amplifiers/mixers/drum machines/synthesizers/DJ equipment
- Multimedia sound systems
- Portable electronics

RK09H Series - 9 mm Multi-Ganged Potentiometer /Rotary Switch

Product Dimensions

RK09H-1

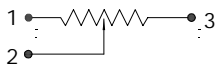
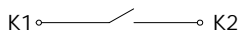
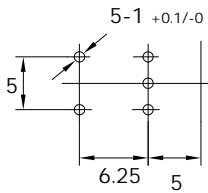
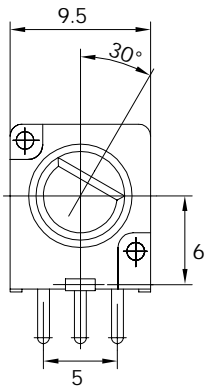
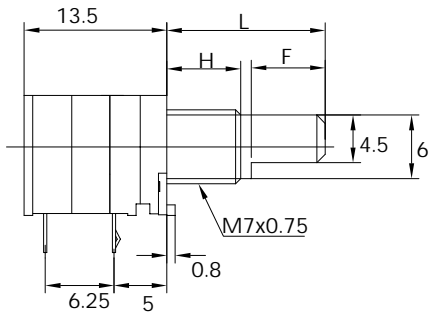

RK09H-2

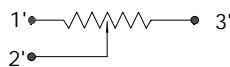
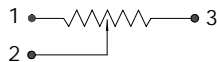
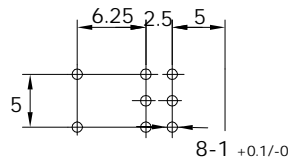
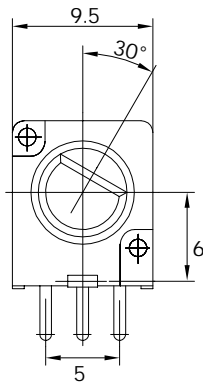
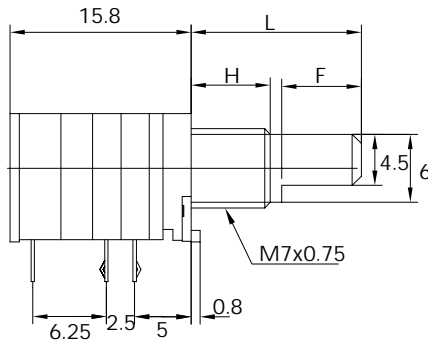

Shaft Styles

F Shaft Style

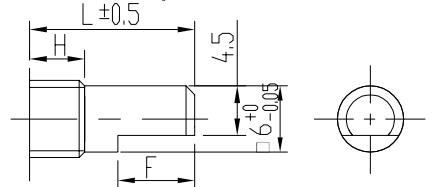

H=5	L	15	20	25	H=7	L	15	20	25
	F	7	12	12		F	7	12	12

P Shaft Style

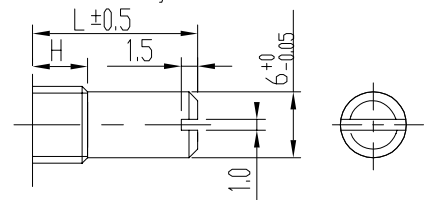

L	15	20	25
---	----	----	----

K Shaft Style

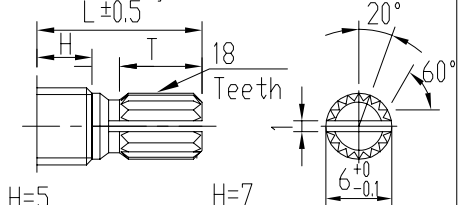

H=5	L	15	20	25	H=7	L	15	20	25
	T	6	10	12		T	6	10	12

General Tolerance

Dimension:

Less than 10 ± 0.3mm

Above 10~30 ± 0.5mm

Above 30~100 ± 1mm

Angle: Above ± 5°